

## 1310nm 155Mbps 3Pin LED TOSA

### EI6C-9010-EN Series

Ver. : **1.1**

#### Type Name: EI6C-9010-EN

#### Product Description:

The LuxNet 1310nm LED TOSA assembly is designed for fiber optic data communication applications. This TOSA can be integrated with different types of ports that are engaged with a multi mode fiber connector to provide good coupling efficiency as light generated by the LED is transmitted into multi mode fiber.

#### Application Note:

- LED

#### Product Specifications:

Absolute Maximum Ratings (T = 25°C)

Parameter	Symbol	Unit	Min.	Max.	Note
Operating Temperature	T <sub>op</sub>	°C	- 40	85	
Storage Temperature	T <sub>stg</sub>	°C	- 40	85	
Solder Reflow Temperature	T <sub>s</sub>	°C		260	10 seconds max.
Reverse Voltage	V <sub>r</sub>	V		2	
Forward Current	I <sub>F</sub>	mA		150	

Electro-Optical Characteristics (T = 25°C, CW, I<sub>F</sub>=60mA):

Parameter	Symbol	Unit	Min.	Typ	Max.	Test Condition
Optical output power	P <sub>o</sub>	uW	35			62.5/125um MM fiber
Wavelength	λ	nm	1280	1310	1350	
Spectral Width (RMS)	Δλ	nm			170	
Forward Voltage	V <sub>F</sub>	V		1.2	1.7	
Rise Time/ Fall Time	T <sub>r</sub> / T <sub>f</sub>	ns			3	10%-90%
Output Power over Temperature	ΔP <sub>o</sub> /ΔT	dB			±3	-40°C to +85°C

*All specifications or information contained herein are subject to change for improvement without notice.  
Further details are available from any LUXNET sales representative.*

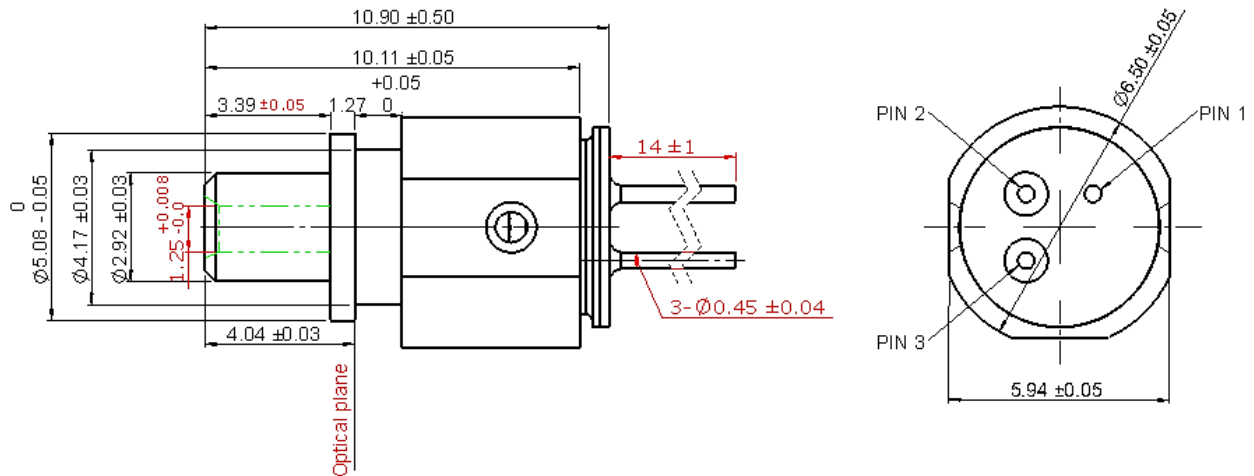
**EI6C-9010-EN (LC TOSA)**
**Dimension: (mm)**
*All dimensions are nominal*

**PINOUT**

Number	Function
1	Case Gnd
2	LED Cathode
3	LED Anode

*All specifications or information contained herein are subject to change for improvement without notice.  
 Further details are available from any LUXNET sales representative.*

---

## Document History

Version	Date (MM/DD/YYYY)	Notes
1.0	01/27/2016	Preliminary datasheet
1.1	04/07/2022	Change new file form and modify correct dimensions

*All specifications or information contained herein are subject to change for improvement without notice.  
Further details are available from any LUXNET sales representative.*